

# Playground Borders

100%  
RECYCLED

MADE IN  
USA

Action Play Systems offers the highest quality playground border in the industry. APS playground borders are 4' 4" long, 4" wide and available in either 8" or 12" heights. Both our 8" and 12" high playground borders feature our patented Surfacing Guide (US Patent #716,113 and D732,357). This guide serves as a ruler on your playground to ensure adequate levels of safety surfacing are maintained. With a quick glance, you can easily see how much surfacing is currently on your playground.

Our 8" high playground borders are perfect for early childhood environments, or when using rubber mulch and when only a 6" depth of loose fill surfacing is required. The 12" high APS playground border is perfect for all playground environments, as well as, raised bed gardening.

Offering a 10-year limited warranty, our product is designed to take the place of wood timbers and offers a permanent, maintenance free solution to keeping your playground safety surfacing where it belongs—on the playground!

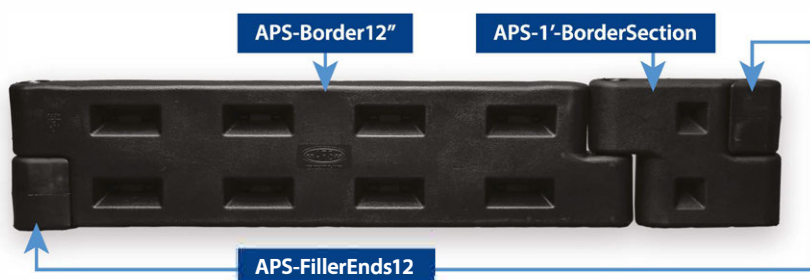



### APS-Border8

8" high Playground Border with Spike  
(also available in GREEN)

### APS-Border12

12" high Playground Border with Spike  
(also available in GREEN)

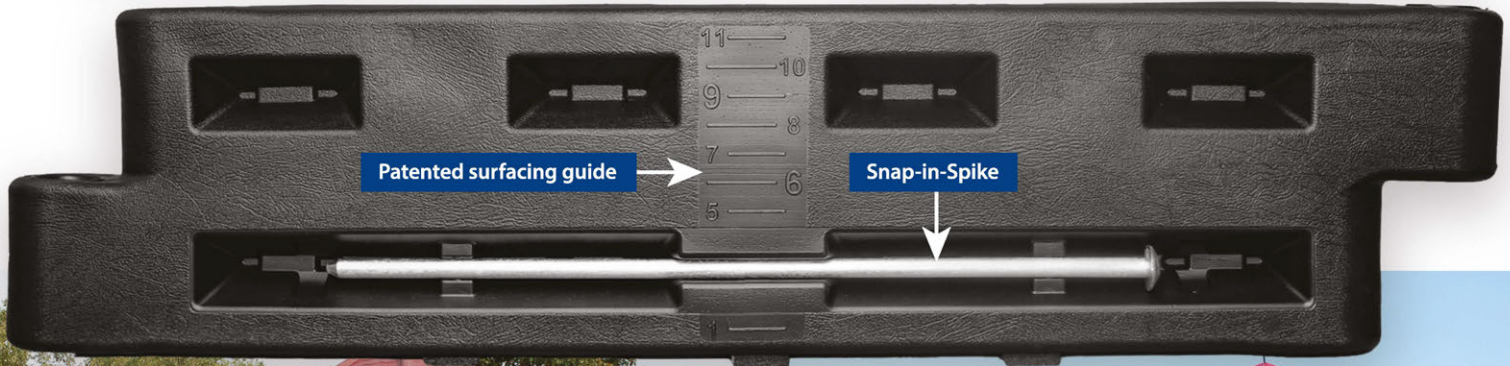

## Border Accessories

We offer a full compliment of accessories to go along with our 8" and 12" playground borders. Our 1' border kit allows you to frame use zones when space is at a premium and a length less than 4' is required. Each kit includes: (2) 1' border sections, (2) 6" filler ends, (2) 100-spike 12".

Our 4" and 6" filler ends provide the means to create a finished opening when a connecting border is not present. The 4" are designed for our 8" playground borders while the 6" are used with our 12" high borders. Both 4" and 6" filler ends are sold in boxes of 6 each.



### APS-FillerEnds8

4" Filler Ends for APS-Border 8 (Box of 6)

### APS-FillerEnds12

6" Filler Ends for APS-Border 12 (Box of 6)

### APS-1'-BorderKit:

(2) 1' Border Section  
(2) 100-filler12"  
(2) 100-spike12"

### 100-spike12

Spike for APS-Border12

### 100-spike8

Spike for APS-Border8



# ADA Playground Access Ramps



Action Play Systems' wheelchair accessible ramp systems are the only true universal playground ramp systems available today. Designed to mount independent of the playground borders; APS full and half ramps provide an ADA/Wheelchair accessible entrance to the playground while offering a clear point of entry and exit

to the playground. Each ADA ramp system includes (2) each 4" and 6" filler ends as well as the necessary spikes for installation. Our APS-ADAFullRamp includes 2 halves while our APS-ADAHalfRamp and APS-ADASidewalkMountRamp include 1 half to provide access into the play area.

## The Department of Justice's revised regulations for Titles II and III of the Americans with Disabilities Act of 1990 (ADA)

These regulations adopted revised, enforceable accessibility standards called the 2010 ADA Standards for Accessible Design, "2010 Standards." On March 15, 2012, compliance with the 2010 Standards was required for new construction and alterations under Titles II and III. March 15, 2012, is also the compliance date for using the 2010 Standards for program accessibility and barrier removal.

Plan and layout installation

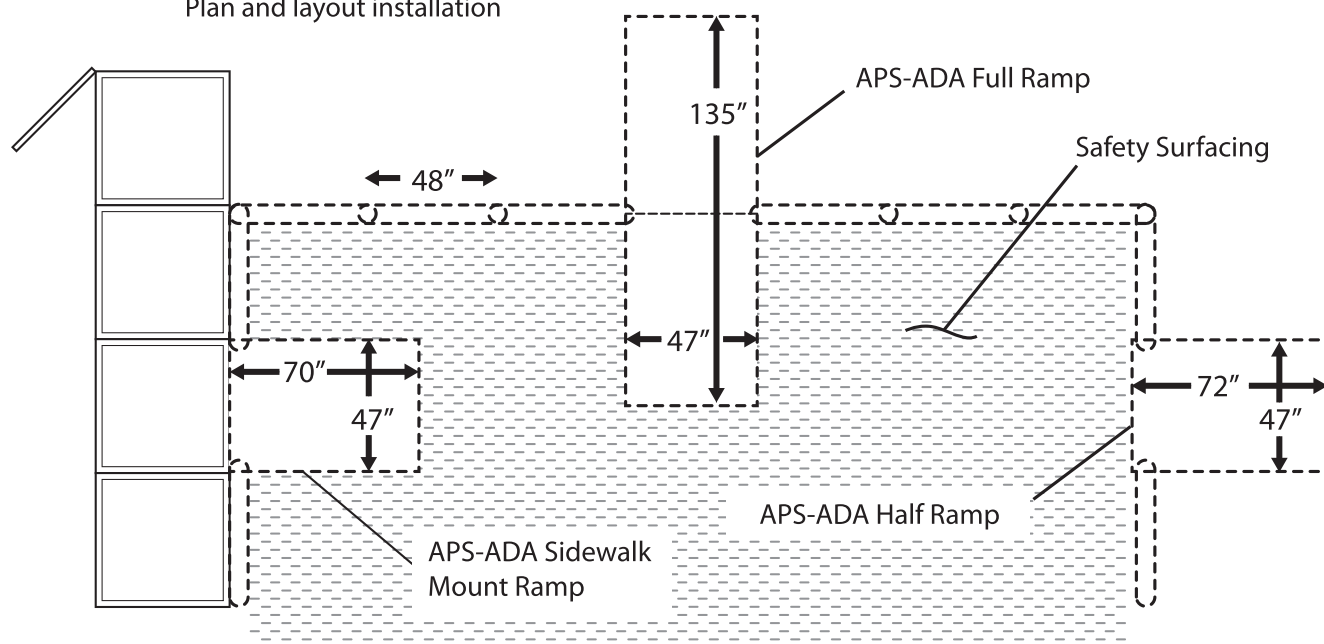

Action Play Systems offers three unique modular ramp systems to provide wheelchair access on your playground designs. All APS modular ramp systems are commercial grade and composed of 100% recycled plastic.

Designed to install independent of our playground borders; APS ramps provide cost effective wheelchair accessibility and a clear point of entry/exit on any playground installation.



### **APS-ADA Half Ramp**

ADA Half Ramp System for 8" or 12" borders

**Ideal for connecting an accessible route to the use zone of a loose fill playground.**

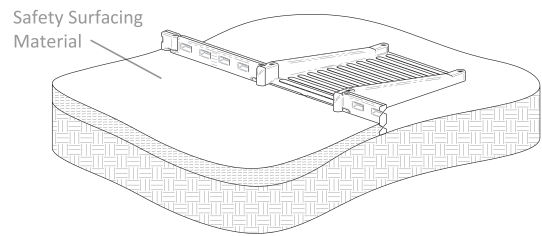

### **APS-ADA Sidewalk Mount Ramp**

ADA Sidewalk Mount Ramp System for 8" or 12" borders

**Ideal for connecting an existing use zone to an adjacent sidewalk.**

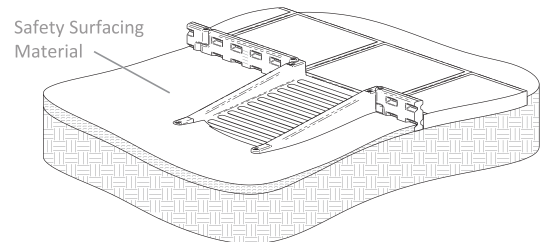

### **APS-ADA Full Ramp**

ADA Full Ramp System for 8" or 12" borders

**Ideal for larger use zones where additional access, egress, and turn-around room is desired.**

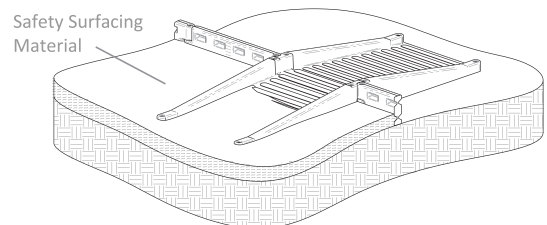



# Everyone is GaGa over **GaGa Ball!**

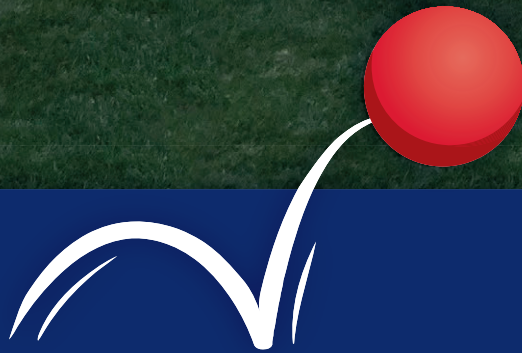

## What is it?

GaGa is a sport for all ages and abilities similar to dodgeball. GaGa translates to “touch-touch” in Hebrew and the game is thought to have originated in Israel. GaGa’s popularity has continued to rise in the US and is extremely popular at camps, schools and playgrounds everywhere!





# Our Pits

Action Play Systems offers 3 sizes of GaGa Ball Pits for indoor or outdoor use. Each kit is constructed utilizing our 12" high playground borders connected with our proprietary stanchions, specifically for our GaGa Ball Pits. Additionally, Action Play Systems GaGa Ball Pits come standard with our exclusive ADA Gate for easy pit entrance and exit, as well as, ADA

wheelchair accessibility. Once installed, our GaGa Ball Pits are 28" high allowing for maximum ball rebound and consistent play. Our stanchions can be permanently anchored if desired (not included) and are coated for maximum durability. Additionally, our proprietary stanchion design allows each wall of the GaGa Ball Pit to be raised 4" for easier cleaning of debris.

## APS-GagaPit15

(24) 100-border12"  
(12) 100-GaGaStanchion

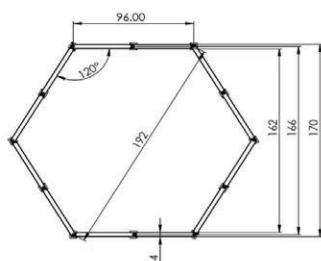

15 FEET - STRAIGHT (24 TIMBER)  
ACROSS FLAT (PIVOT TO PIVOT): 13' 10"  
ACROSS FLAT INSIDE DIMENSION: 13' 6"  
INSIDE AREA (SQ FT): 158.5

## APS-GagaPit20

(32) 100-border12"  
(16) 100-GaGaStanchion

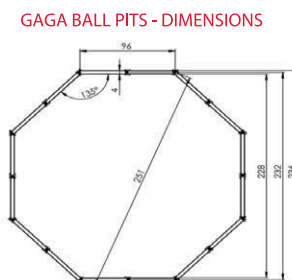

20 FEET - STRAIGHT (32 TIMBER)  
ACROSS FLAT (PIVOT TO PIVOT): 19' 4"  
ACROSS FLAT INSIDE DIMENSION: 19'  
INSIDE AREA (SQ FT): 298.6

## APS-GagaPit26

(40) 100-border12"  
(20) 100-GaGaStanchion

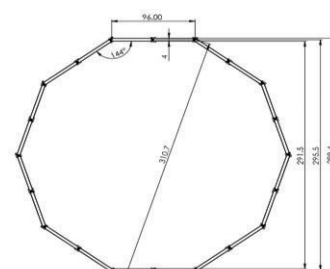

26 FEET - STRAIGHT (40 TIMBER)  
ACROSS FLAT (PIVOT TO PIVOT): 24' 8"  
ACROSS FLAT INSIDE DIMENSION: 24' 4"  
INSIDE AREA (SQ FT): 479.4



APS-GAGAPIT15



APS-GAGAPIT20



  
ADA Gate  
Standard



**Springdale elementary schools love gaga ball!**  
Turnbow Elementary School – Springdale, AR





- Easy to Install
- No hardware required
- Patent Pending
- Portable
- Panels nest for easy storage

The perfect compliment to our standard GaGa Pits, GaGa2Go is portable, easy to install, dismantle, and stores neatly in a 30" x 48" x 25" area. Requiring no hardware, GaGa2Go is the perfect answer for indoor and/or temporary use for

schools, churches, camps and more. Looking to move up from that backyard swingset your kids have outgrown? GaGa2Go is perfect for residential use in garages, basements, driveways and more!



“This product is so much fun! The kids love it and that is why we decided to buy a second one.”

“Fantastic product! Timely delivery. Easy to move and store. Easy to set up. Durable! High quality.”



# Swing/Slide Wear Mats

Reduce maintenance in high traffic areas • Easy to install

## APS-Swing/ SlideWearMat

- 40" x 40" x 1.5"
- Beveled edges
- 64 lbs.
- Waffle bottom construction



## APS-SwingMat

- 3' x 5' x 2"
- Beveled edges
- 115 lbs.
- Waffle bottom construction



**APS-ResidentialWearMat**  
24" x 40" x 1" (Green)

As recommended by the CPSC Public Playground  
Safety Handbook  
2.4.2.2 Loose Fill Surfacing Materials

2. Loose-fill surfacing requires frequent maintenance to ensure surfacing levels never drop below the minimum depth. Areas under swings and at slide exits are more susceptible to displacement; special attention must be paid to maintenance in these areas. Additionally, wear mats can be installed in these areas to reduce displacement.





## Spinner Wear Mats

Action Play Systems offers a full line of wear mats for additional high traffic areas of your playgrounds. Designed to reduce wear patterns around modern “spinners” or “rotating” equipment we offer 5 uniquely sized mats to work with most equipment on the market today.

**APS WearMats Are Perfect  
For Today’s “Spinning” Equipment!  
But Don’t Take Our Word For It!**



"We ordered a spinner mat and installed it in early December...These are perfect for the Burke Comet Spinner. Kathy and I have installed them for customers and they fit good and protect the turf from wearing through. The all thread works really good. This is by far the best mat on the market for a spinner the size of the Comet.

We are going to start quoting these with all orders that have a spinner on them. We constantly get maintenance calls about the wood fiber being trenched out or the turf wearing through. This is an easy solution to an ongoing maintenance problem."



### **APS-SpinnerWearMat**

- 48" Diameter
- 6" Center opening
- 2" thick, beveled edges around the perimeter
- 110 lbs.



# Wear Mats



## APS-WearMat-6'

- 2 piece wear mat
- 6' Diameter
- 6" Center opening, with 6" plug for a uniform mat
- 2" thick, beveled edges around the perimeter
- 235 lbs.



## APS-WearMat-8'

- 4 piece wear mat
- 8' Diameter
- 6" center opening, with 6" plug for a uniform mat
- 2" thick, beveled edges around the perimeter
- 355 lbs.



## APS-WearMat-10'

- 8 piece wear mat
- 10' Diameter
- 4' center opening, 3' radius wear mat
- 2" thick, beveled edges around the perimeter
- 575 lbs.



## APS-WearMat-14'

- 16 piece wear mat
- 14' Diameter
- 6' center opening, 4' radius wear mat
- 2" thick, beveled edges around the perimeter
- 1,075 lbs.